

Summing Junction Box

FEATURES

- Die cast aluminum
- Up to 4 transducers
- Fast and accurate connection
- Easy connection to Load Cell Tester 1008
- IP66

APPLICATIONS

- All applications for weighing and force with up to 4 transducers

DESCRIPTION

Rugged summing junction box, build for harsh environment. Easy connection to load cell tester model 1008 for testing of individual transducer, calibration, service and diagnostic.



OUTLINE DIMENSIONS

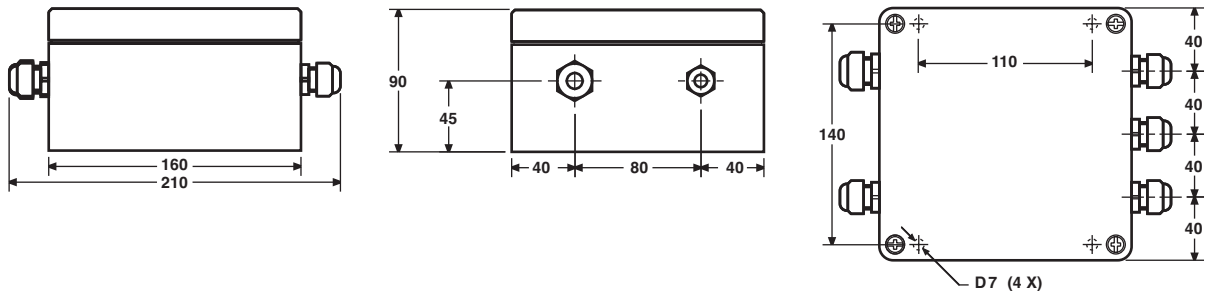

ADAPTER

IMPORTANT

Do not discard.
Adapter must be mounted during operation.

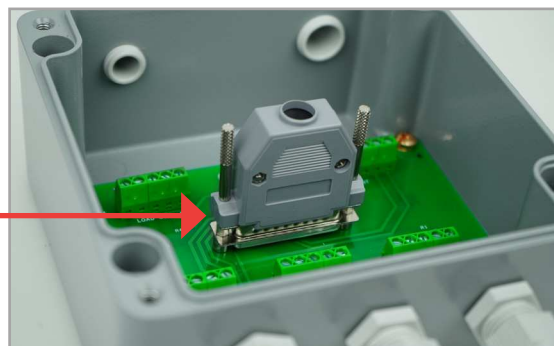

Summing Junction Box

SPECIFICATIONS	
PARAMETER	VALUE
Capacity	Up to 4 transducers
Connections	Terminal blocks, ground screws
Enclosure	Die cast aluminium
Operating temperature range	-40 to +90°C
Box size	160 × 160 × 90 mm (L × W × H)

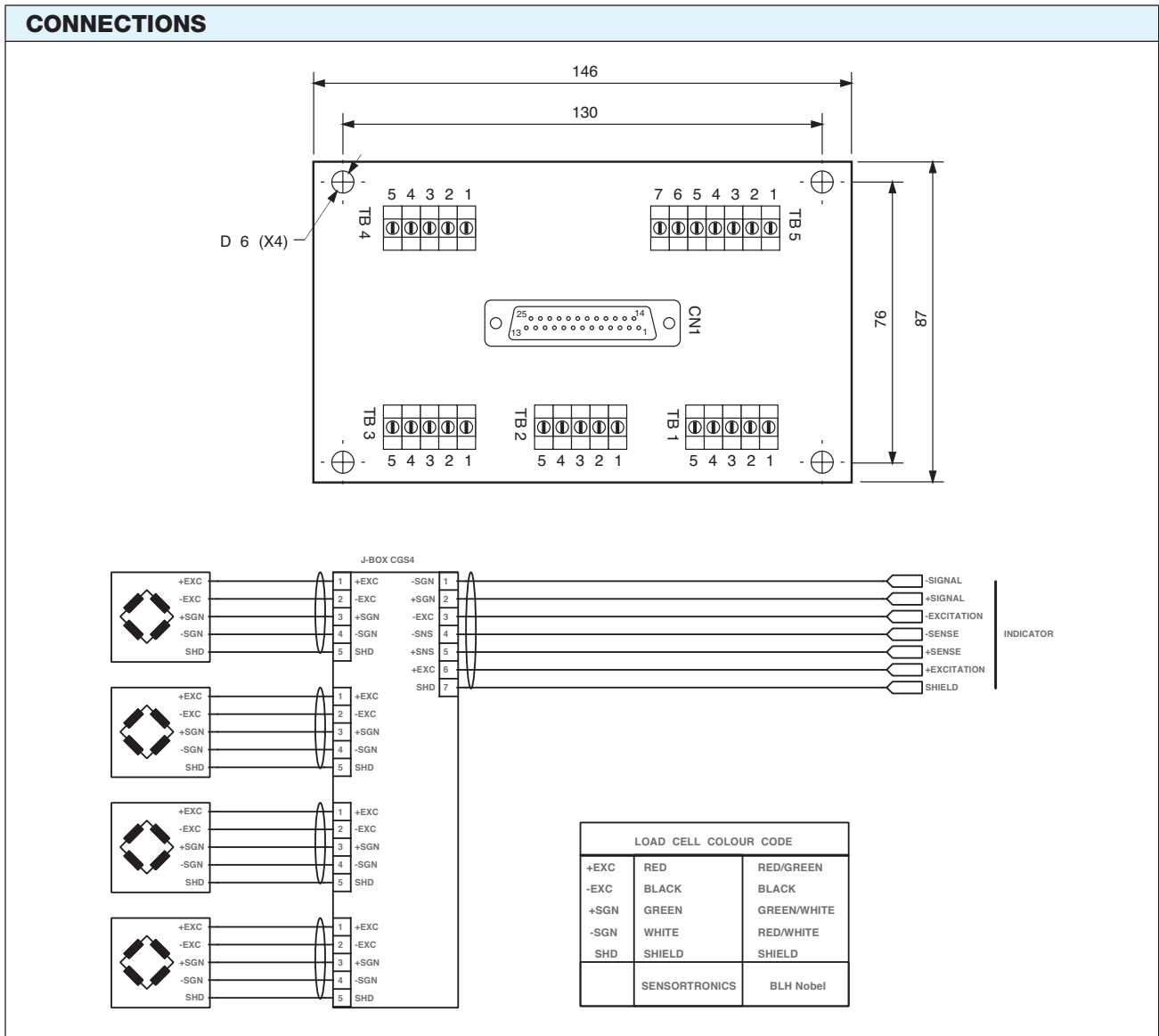

Disclaimer

ALL PRODUCTS, PRODUCT SPECIFICATIONS AND DATA ARE SUBJECT TO CHANGE WITHOUT NOTICE.

Vishay Precision Group, Inc., its affiliates, agents, and employees, and all persons acting on its or their behalf (collectively, "VPG"), disclaim any and all liability for any errors, inaccuracies or incompleteness contained herein or in any other disclosure relating to any product.

The product specifications do not expand or otherwise modify VPG's terms and conditions of purchase, including but not limited to, the warranty expressed therein.

VPG makes no warranty, representation or guarantee other than as set forth in the terms and conditions of purchase. **To the maximum extent permitted by applicable law, VPG disclaims (i) any and all liability arising out of the application or use of any product, (ii) any and all liability, including without limitation special, consequential or incidental damages, and (iii) any and all implied warranties, including warranties of fitness for particular purpose, non-infringement and merchantability.**

Information provided in datasheets and/or specifications may vary from actual results in different applications and performance may vary over time. Statements regarding the suitability of products for certain types of applications are based on VPG's knowledge of typical requirements that are often placed on VPG products. It is the customer's responsibility to validate that a particular product with the properties described in the product specification is suitable for use in a particular application. You should ensure you have the current version of the relevant information by contacting VPG prior to performing installation or use of the product, such as on our website at vpgsensors.com.

No license, express, implied, or otherwise, to any intellectual property rights is granted by this document, or by any conduct of VPG.

The products shown herein are not designed for use in life-saving or life-sustaining applications unless otherwise expressly indicated. Customers using or selling VPG products not expressly indicated for use in such applications do so entirely at their own risk and agree to fully indemnify VPG for any damages arising or resulting from such use or sale. Please contact authorized VPG personnel to obtain written terms and conditions regarding products designed for such applications.

Product names and markings noted herein may be trademarks of their respective owners.

Copyright Vishay Precision Group, Inc., 2014. All rights reserved.